

Cathedral Square tree evaluation



FRAME THE SQUARE
September - 2020



As part of undertaking a redesign effort for the right of way area around Cathedral Square, a tree evaluation was completed to review the existing street trees in the terrace area. Health, shape, species, location, utility conflicts, and opportunity for coordination into the proposed design were factors considered for each tree.

The following evaluation was completed and utilized during the schematic design of the project to maintain existing trees that are in good condition that work within a cohesive redesign philosophy of the park. Every effort was made to incorporate existing trees into the design, but consideration for the long term goals of the design and the park, utilizing this opportunity to create a unique space with organized plantings, was also a driver in the schematic design.

FRAME THE SQUARE
cathedral square tree evaluation

existing tree location map

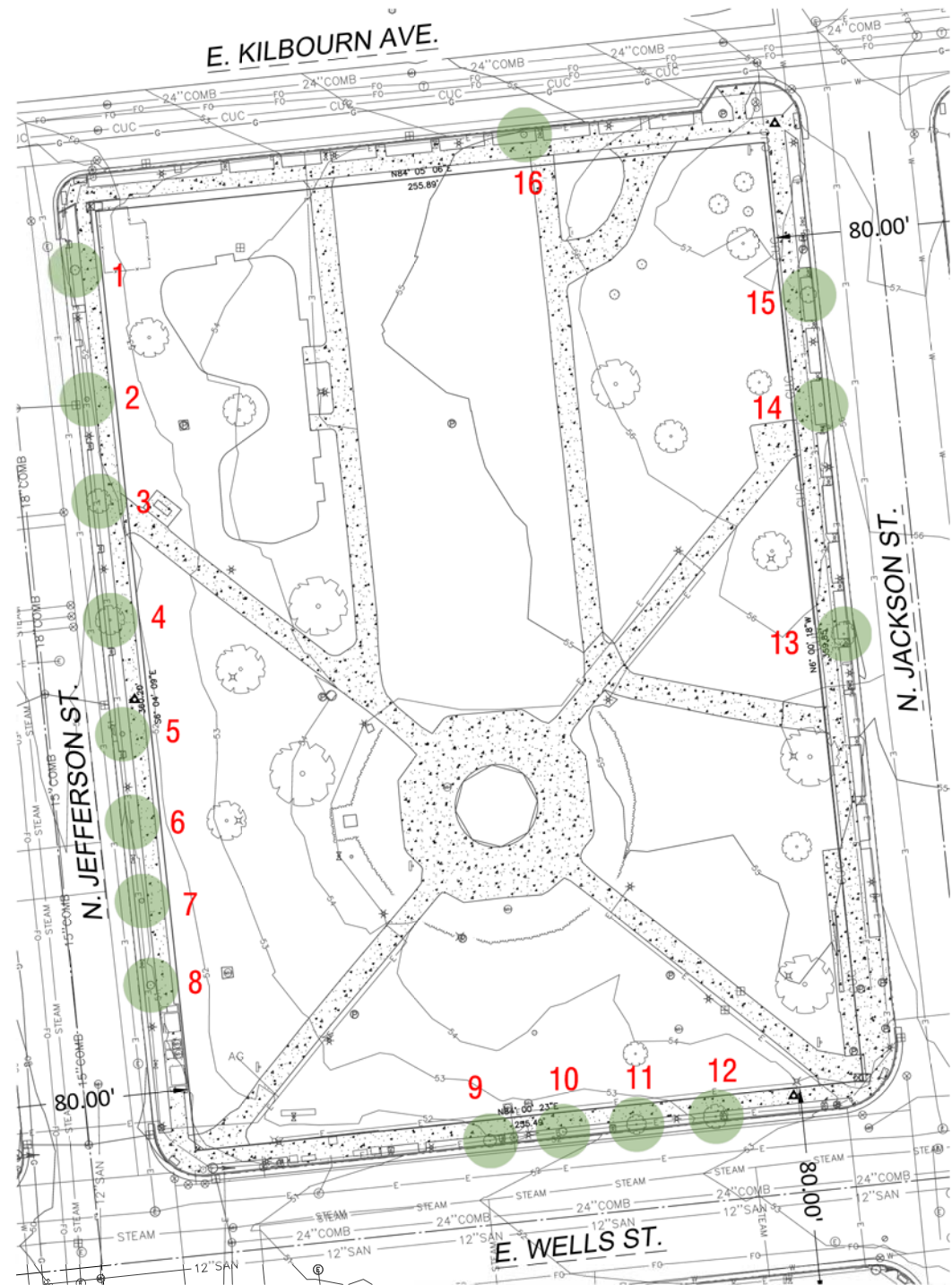



#1 | 6/10 | 9" Kentucky Coffeetree
notes: slight disease or stress signs

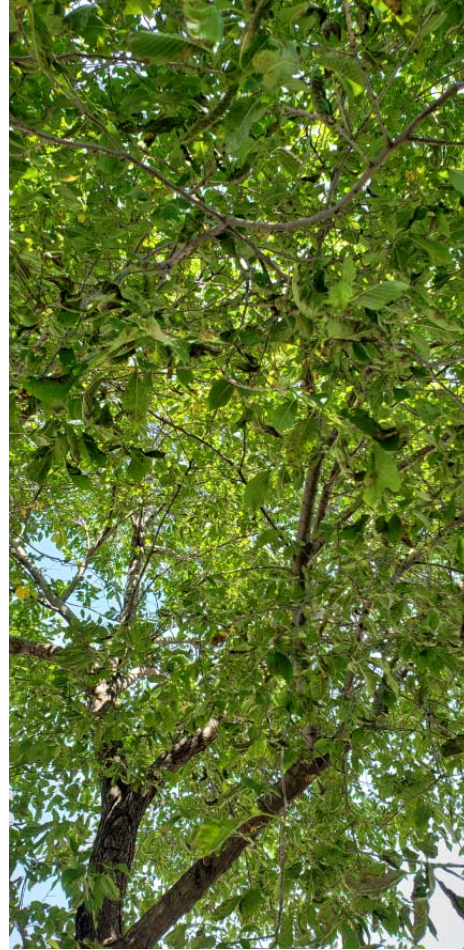

#2 | 10/10 | 4" Gallery Pear
notes: young, could be replaced if necessary



#3 | 10/10 | 14" Elm
notes: established, good form



#4 | 10/10 | 14" Maple
notes: established, good form



#5 | 5/10 | 3" Elm
notes: slight disease on the leaves



#6 | 9/10 | 1.5" Oak
notes: young, could be replaced if necessary



#7 | 2/10 | 2.5" Pear
notes: many suckers

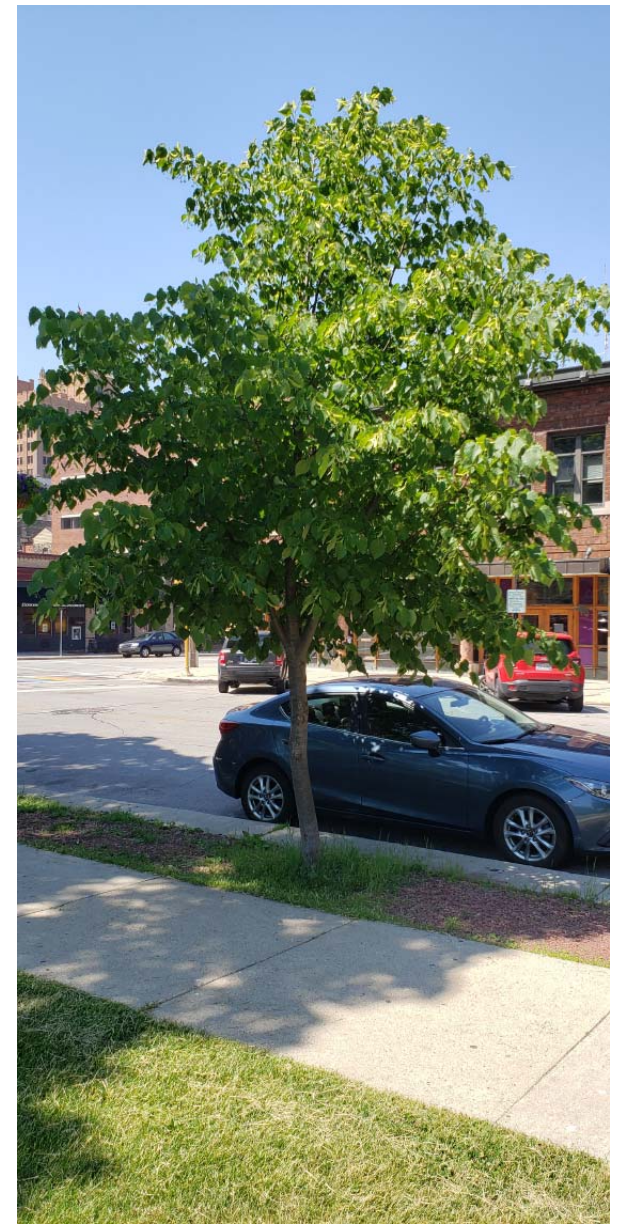
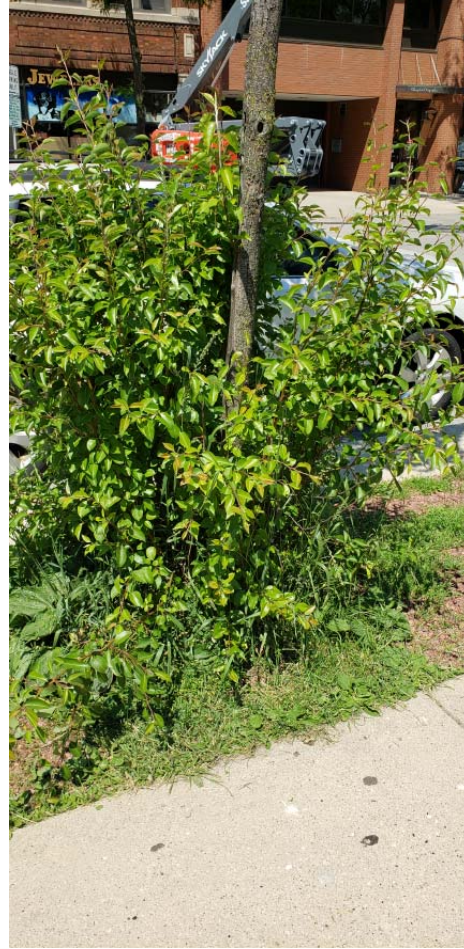

#8 | 10/10 | 4" Linden
notes: young with round canopy



#9 | 6/10 | 10" Maple
notes: lopsided canopy and trunk
leaning towards the street

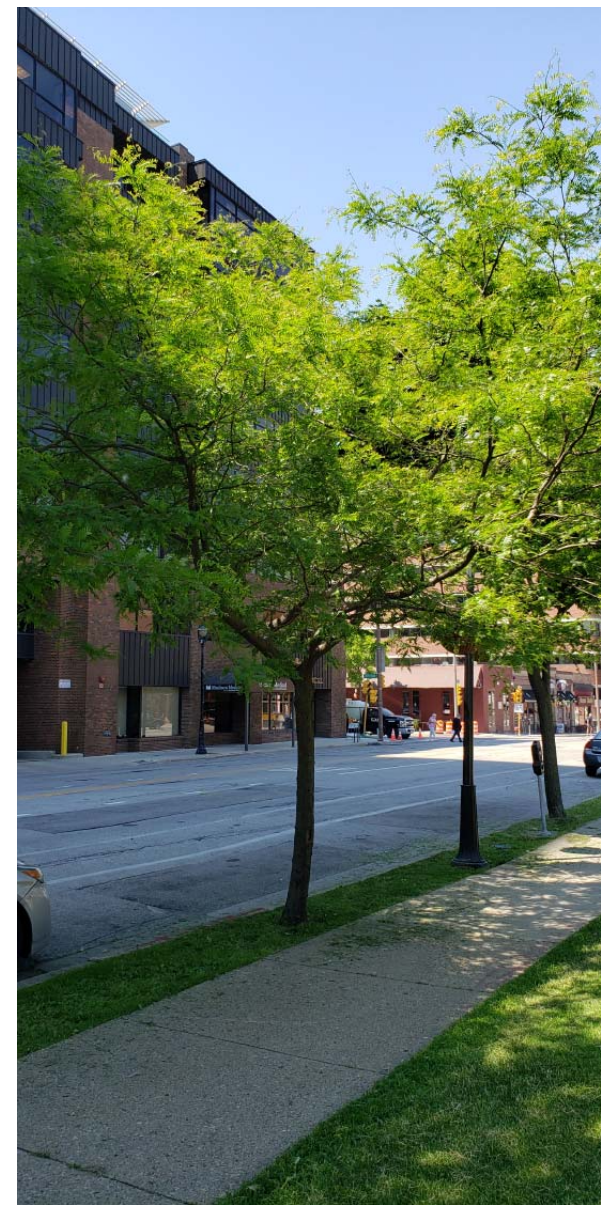

#10 | 9/10 | 9" Honeylocust
notes: wide vase shape, missing main
leader, could be replaced

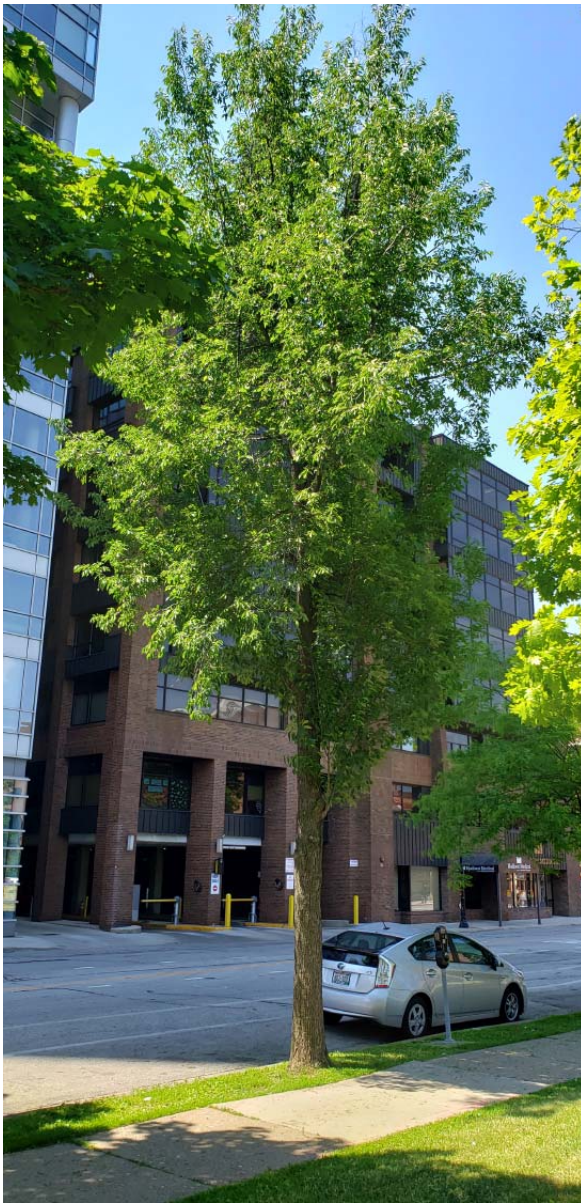

#11 | 9/10 | 14" Ash
notes: narrow form, likely to die from
emerald ash borer



#12 | 5/10 | 16" Maple
notes: irregular crown, significant mower
damage causing tree to slowly decay

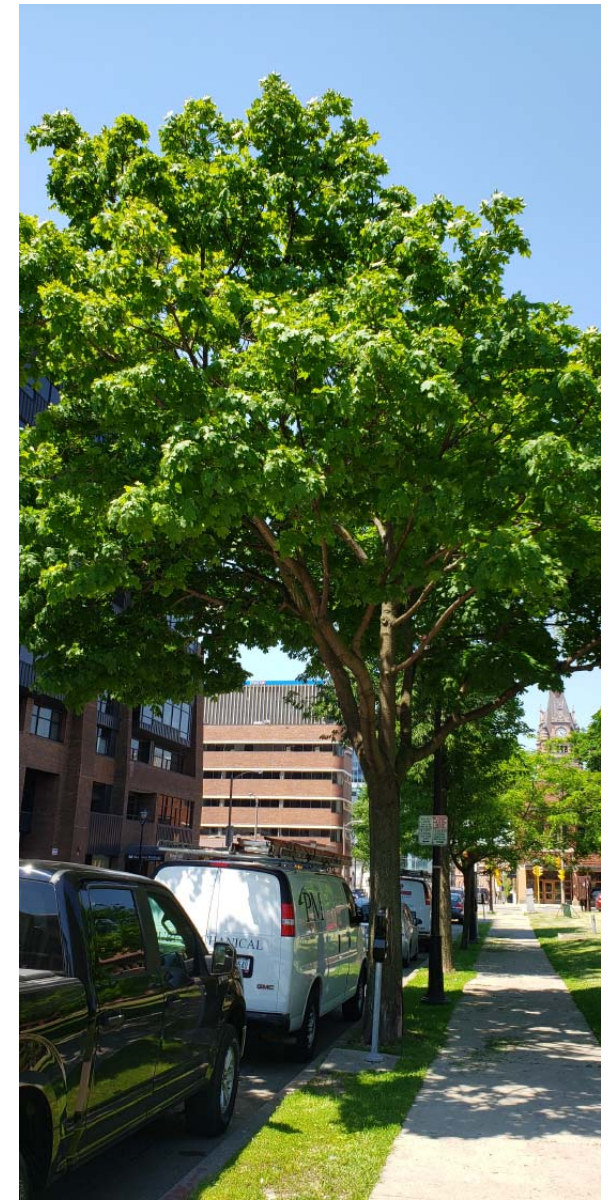

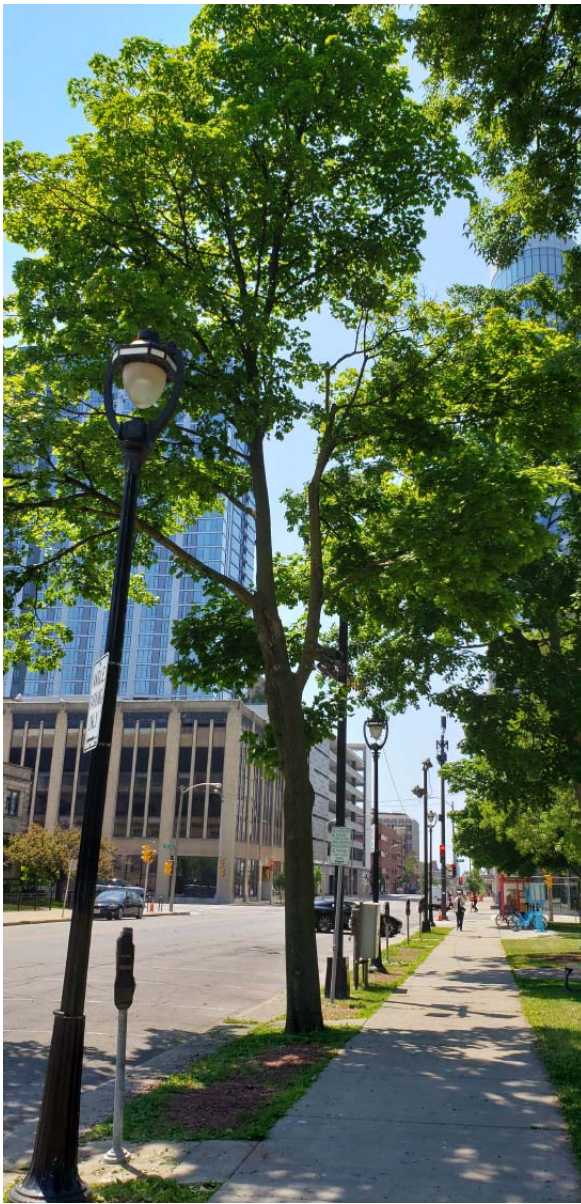

#13 | 6/10 | 14" Maple
notes: irregular crown, loss of limbs



#14 | 5/10 | 2.5" Elm
notes: young, slight disease on leaves

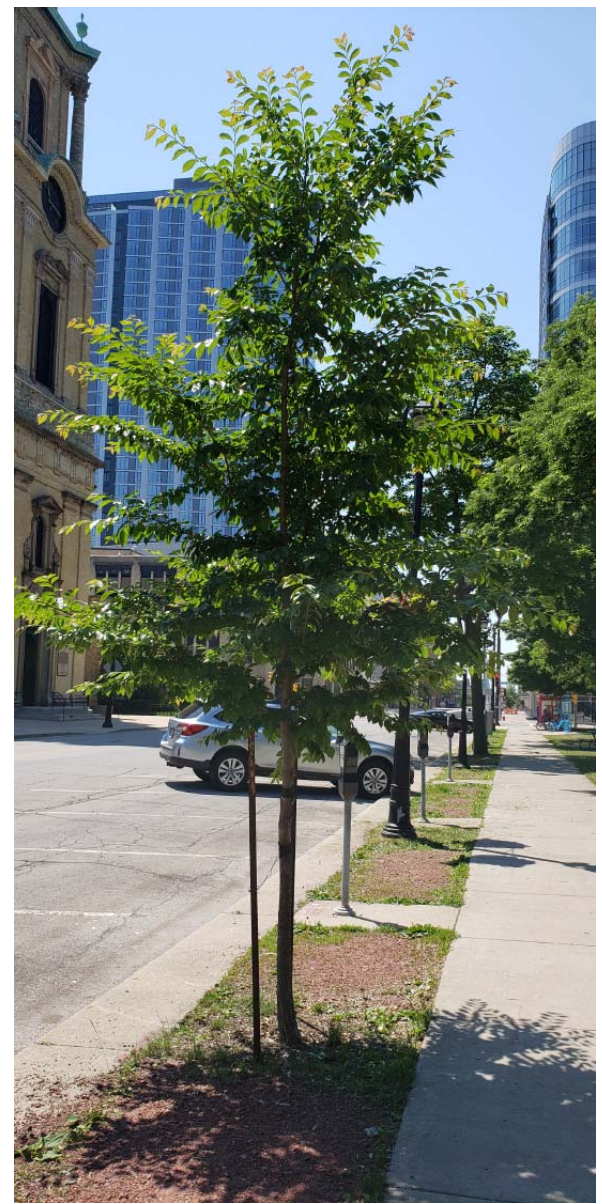



#15 | 10/10 | 12" Kentucky Coffeetree
notes: established, good form

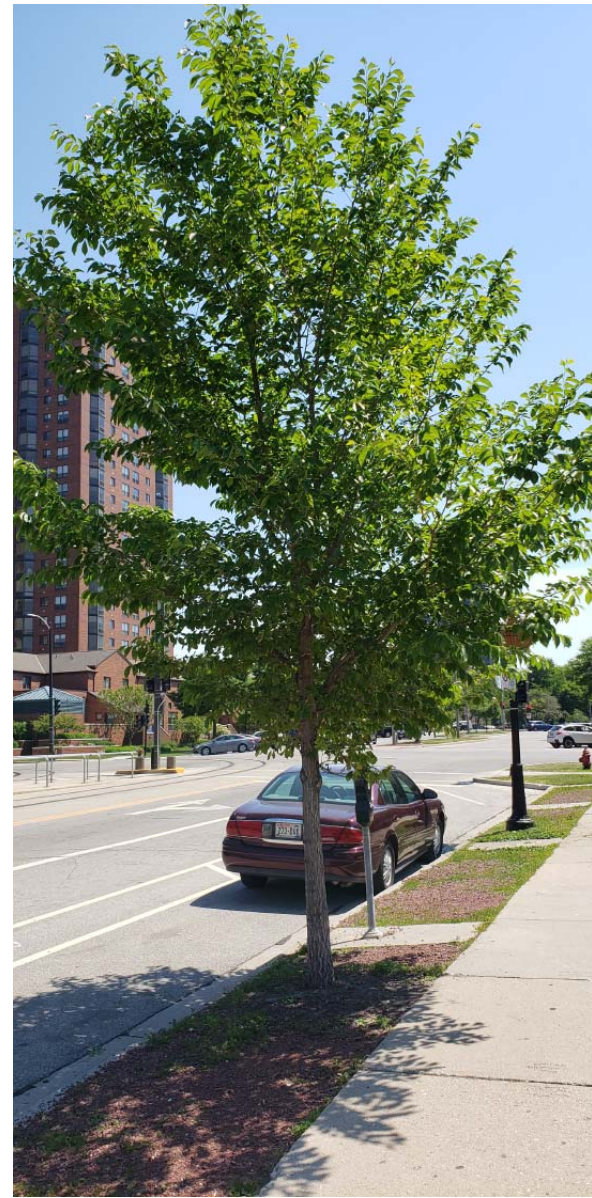

#16 | 10/10 | 6" Elm
notes: young, could be replaced if
necessary

- x: existing to be removed
- e: existing to remain
- r: existing to be replaced with a new tree
- n: new tree to be installed (new placement)

SCALE, FEET 0 20 40

CATHEDRAL OF ST. JOHN THE EVANGELIST

N. JACKSON ST.

E. WELLS ST.

N. JEFFERSON ST.

E. MELBOURNE AVE.

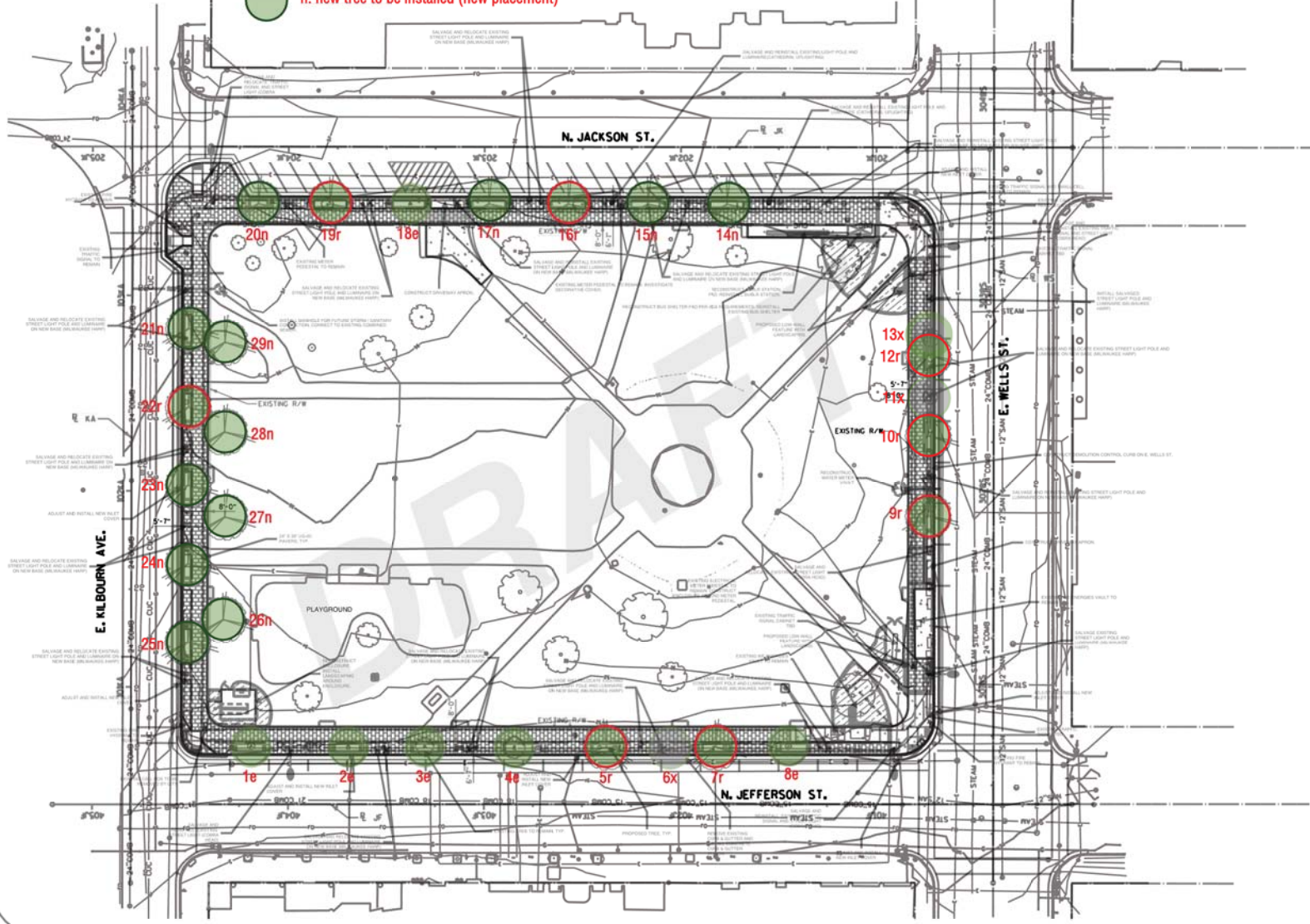

FRAME THE SQUARE

No.	Revisions/Notes	Date

Figures for a "typical" site - not for construction

SCHEMATIC DESIGN
NOT FOR CONSTRUCTION

HNTB

HNTB CORPORATION
250 E WISCONSIN AVE., SUITE 2000
MILWAUKEE, WI 53202

KAPUR & ASSOCIATES
7711 N. POIT WASHINGTON RD.
MILWAUKEE, WI 53217

Project name and location
FRAME THE SQUARE
CATHEDRAL SQUARE PARK
320 W WELLS ST.
MILWAUKEE, WI 53202

Client name and location
CATHEDRAL SQUARE

Project	77321	Sheet	
Date	12/1/2020 9:23:46 PM	Scale	1" = 20'

FRAME THE SQUARE

tree evaluation exhibit plan